

BELLY DUMP

OWNER'S MANUAL



Intramet



BELLY DUMP



BELLY DUMP

Thank you for choosing us! We are thrilled to be a part of your journey and look forward to supporting you along the way!

Please complete this form right after your purchase

Owner: _____

Address: _____

Phone: _____

Purchase Date: _____

Online help



For any question contact your dealer.

Thanks again and enjoy your product

Disclaimer

The driver is responsible for the safe operation of this trailer. For further details keep reading the owner's manual.



BELLY DUMP





BELLY DUMP

Contents

IMPORTANT SAFETY INFORMATION.....	3
INSPECTION, SERVICE AND MAINTENANCE.....	4
DAILY INSPECTION.....	4
PAINT CARE & CORROSION PREVENTION.....	4
PREVENTATIVE MAINTENANCE.....	5
FRONT TRAILER CONNECTORS.....	6
BELLY GATE CYLINDERS.....	7
WARRANTY INFORMATION.....	8
OPERATING BELLY GATE.....	10
DOOR HARDWARE.....	11
ADJUSTMENT BAR.....	11
TURNBUCKLE.....	11
MAINTENANCE UNIT.....	12
PUSH PULL BLOCK.....	13
TARP SYSTEM.....	14
FLIP TARP SYSTEM.....	14
WARRANTY.....	15
WARRANTY.....	18



BELLY DUMP

IMPORTANT SAFETY INFORMATION

YOU MUST READ THIS MANUAL and get entirely familiar with all of its operation instructions and safety concerns before attempting to load, unload, or operate this trailer. ALWAYS FOLLOW THESE PRECAUTIONS TO AVOID SERIOUS INJURY OR DEATH:

1. Do not allow unqualified, untrained, or careless personnel to operate the trailer. Do not use the trailer for a purpose for which it was not intended.
2. Each person at the user's facility who may be involved with installing, operating, servicing, inspecting, maintaining, or repairing the trailer must read the complete operating instructions and carefully study and understand the safety instructions. All actual and potential operators should confirm their having done so in writing.
3. The trailer must be serviced and maintained only by authorized knowledgeable personnel for safe operation of the trailer. Only the manufacturer or authorized technicians should carry out more than minor repairs.
4. Do not allow anyone who is not physically fit or mentally alert near the trailer or its operating area. Be constantly alert to possible hazards on or around the trailer.
5. Keep a safe distance at all times from any moving parts.
6. When unloading the trailer:
 - a) Long hair must be protected by headgear.
 - b) Do not wear loose apparel such as ties, scarves, etc.
 - c) Remove all wristwatches and jewelry.
 - d) Wear only approved industrial grade eye protection or a face guard to protect against flying debris.
7. Do not allow tools or other loose objects to be placed on top of or around the trailer.
8. At the very first sign of any problem and before attempting any troubleshooting or maintenance, the trailer must be stopped.
9. Safety features must not be removed, dismantled, altered, put out of operation or relocated. All guards and safety devices are to be re-fitted and in place after changeovers, servicing, or making repairs and before the trailer is used. All safety devices must be checked at regular intervals for correct operation.
10. Do not remove safety signs or warning decals from the trailer. Product safety signs should be periodically inspected and cleaned as necessary. Product safety signs should be replaced when they are no longer legible at a normal viewing distance. Replacements are available from INTRAMET (INGENIERIA EN TRANSFORMACIONES METALICAS S.A DE C.V).
11. Follow all workplace safety and accident prevention regulations applicable to the operation of the trailer. Comply with local, state, and/or federal environment regulations, including those governing airborne dust particles.
12. Designate a person to be responsible at any given time for installation, commissioning, operating and repair of the trailer so the responsibility for safety will not be lost.
13. The trailer has been designed and built with original INTRAMET (INGENIERIA EN TRANSFORMACIONES METALICAS S.A DE C.V) parts only. Only original INTRAMET parts must be used for maintenance or repair. Use of other parts will void your warranty.
14. Do not perform modifications to or reconstruction of the trailer without first getting written approval from INTRAMET.
15. The cleanliness and tidiness of the trailer and its surrounding area must be ensured through appropriate instructions, routine inspections, and cleaning.



BELLY DUMP

INSPECTION, SERVICE AND MAINTENANCE

DAILY INSPECTION

It is important that your Belly Dump trailer be inspected and serviced on a regular basis to keep it in safe and in a functional condition. Regular maintenance will also save you money in costly repairs over time. A daily inspection of the following items should be performed before using the trailer:

Trailer	Suspension & axles	Tarps
<ul style="list-style-type: none">• Hopper• Kingpin area• Fifth wheel plate• Framework• Bolts and fasteners• Ladder• Mud flaps	<ul style="list-style-type: none">• Axle alignment• Hub oil level• Brake adjustments• Brake pad thickness• Wheels• Tires	<ul style="list-style-type: none">• Tarp hardware• Tarps

PAINT CARE & CORROSION PREVENTION

Your INTRAMET Belly Dump trailer is painted with a 4-step painting process. This paint is designed to provide longer-lasting corrosion resistance as well as a higher quality finish. Washing your trailer on a regular basis is the greatest method to protect the finish and help prevent corrosion, especially if it has been exposed to road salt or other ice, road oil or tar, or any other potentially corrosive element. Transporting corrosive materials such as salts and fertilizers will void the paint warranty.

Normal use can result in minor nicks or chips in the paint. Repair any chips or scratches in the finish with matching touch-up paint. This is especially crucial for carbon steel trailers since even small sections of bare metal can quickly rust. The expense of mending any chips is the owner's obligation.



BELLY DUMP

PREVENTATIVE MAINTENANCE

We recommend that you follow the general preventative maintenance schedule below. The intervals given are for nominal operating conditions; service more frequently if the trailer is used in an overly humid or dusty condition.

After the first 50 miles

- Check torque of cap nuts or flange nuts on each wheel

After the first 1,000 miles

- Check torque of suspension hardware
- Check alignment of suspension

Every 5,000 miles or once a month (whichever comes first)

- Wash trailer thoroughly with a mild detergent and water
- Check general structural condition for corrosion or cracks
- Inspect kingpin area
- Check clearances and torque of air-ride suspension system
- Visually check alignment of suspension
- Check condition of lights
- Check wiring harness for cracking or chafing
- Check hydraulic and pneumatic lines for signs of leakage or wear
- Check hinges on rear door(s) for signs of damage
- Lubricate hinges, latches, and bearings (if applicable) on rear door(s)
- Inspect brake components for proper adjustment and for any sign of damage
- Check tires for excessive wear and proper inflation
- Check wheel nuts for proper torque
- Check wheel seals for leaks
- Check level of oil in axles
- Check conveyor system for excessive wear or damage
- Check condition of tarp system, if installed
- Check condition and security of mud flaps

Fifth wheel area inspection

The fifth wheel area must be kept clean and free of dirt and foreign materials. This includes the area between the kingpin plate and the body of the trailer where the conveyor travel. Build of materials can cause binding or other serious damage if allowed to remain in this area.

FRONT TRAILER CONNECTORS



Service Supply

Emergency Supply

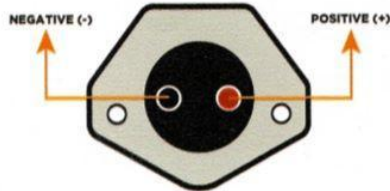

Part: 76605

2 POLE SOCKET

The electric tarp system, it is connected to this 2-pole socket in order to operate the tarp

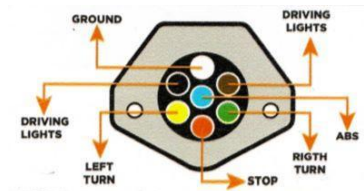

Part: 593084

7 POLE SOCKET

The 7-pole socket is a standard plug on all trailers. This connector is used to feed every light of the trailer such as the side marker lights, tail lights, brake lights and the ABS valve for the brake system.

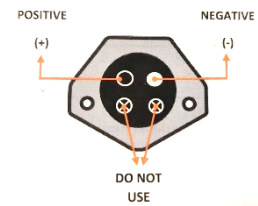

Part: 15-400

4 POLE SOCKET

The 4-pole socket is used to activate the pneumatic cylinder to control the gate.



BELLY DUMP

BELLY GATE CYLINDERS



Part: DAP8-100-30

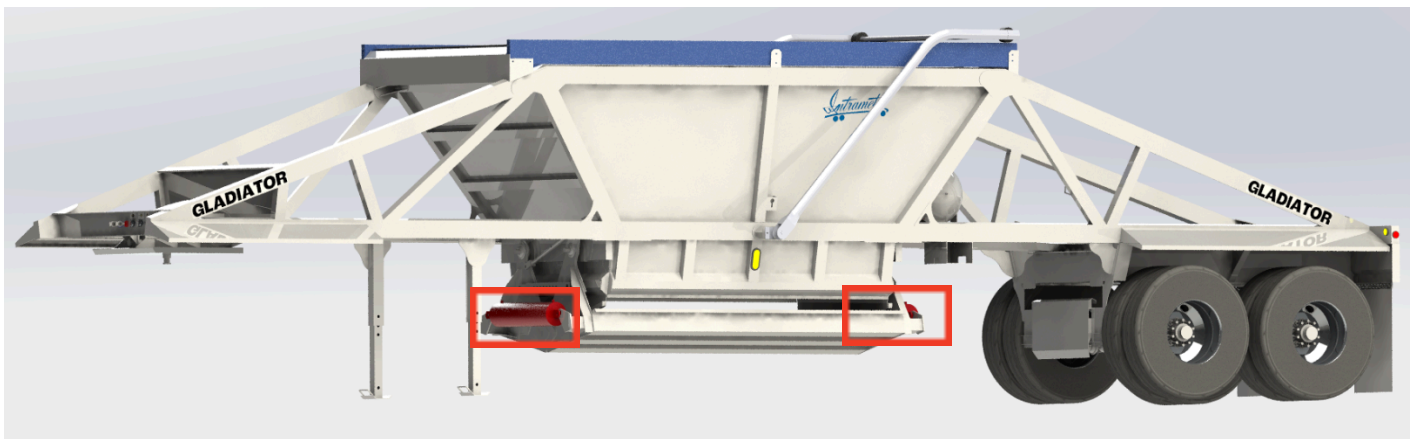

WARRANTY INFORMATION

Custom Hoists, Inc.® warrants only products of its manufacture against operational failure caused by defective materials or workmanship which occur during proper and normal use within 24 months from the date of purchase from Custom Hoists, Inc.® Custom Hoist, Inc.® reserves the right to determine what is proper and normal use.

Packing, wipers, bearings and bushings which are subject to wear caused by internal and external contamination, as well as from normal operating conditions, are not warranty items. Failures initiated by forms of oxidation are also not considered warranty failure.

Custom Hoists® shall not, under any circumstances, be liable for labor for removal and installation expenses, loss of time, manufacturing costs, materials, loss of profits, incidental, special or consequential damages, direct or indirect.

Custom Hoists, Inc.'s® only obligation is to repair or replace, at its election, free of charge, any part of the product that its inspection shows to be defective and, if appropriate, the lowest round trip transportation charges from Custom Hoists'® original customer to Hayesville, Ohio and return, but excluding all transportation costs from Custom Hoists'® customer to its customer.

A return authorization number must be obtained from authorized Custom Hoists'® personnel prior to returning any products for warranty consideration. All claims must be accompanied by a complete written explanation of claimed defects and the circumstances of operational failure. Products returned for warranty consideration shall be shipped to Custom Hoists® freight prepaid with the return authorization attached.

In the event that a product is repaired under warranty, that product shall carry the remainder of the original warranty period.

This limited warranty is in lieu of all other warranties of any nature, express or implied, including, but not limited to, warranties for merchantability or fitness or for any measure of service or suitability or for a specific purpose notwithstanding any disclosure to Custom Hoists® of the use to which the product is to be put.

This express limited warranty is the sole warranty of Custom Hoists, Inc.® There are no warranties which extend beyond the limited warranty herein expressly set forth.

Custom Hoists, Inc.® shall not be liable for loss of time, manufacturing costs, labor, material, loss of profits, incidental, special or consequential damages, direct or indirect, because of defective products, whether due to claims arising under the contract of sale or independently thereof, and whether or not such claim is based on contract, tort or warranty.

The sale of products of Custom Hoists, Inc.® under any other warranty or guarantee, expressed or implied, is not authorized and there are no warranties made to goods or products manufactured by anyone other than Custom Hoists, Inc.®



BELLY DUMP

OPERATING BELLY GATE

PNEUMATIC DOOR

The bottom gate has a mechanical closing system that works with pneumatic cylinders which the versa valve activates. This valve, located in the chassis on the axles, can be activated from inside the cab or manually. Once the valve is activated it will open the cylinders to the predetermined position and keep it in place, once the valve is shut off it will close the gates, while still keeping pressure to ensure the gates stay closed.

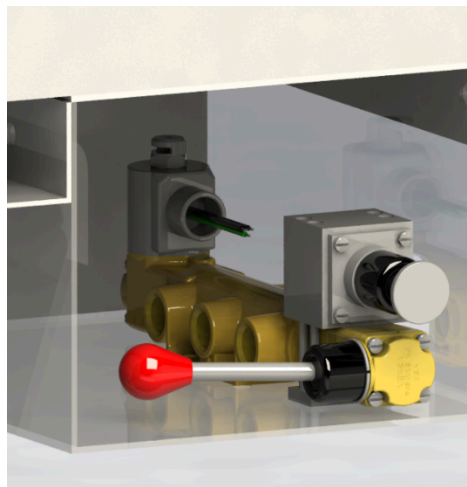

Part: VGK-4523-20C-D012

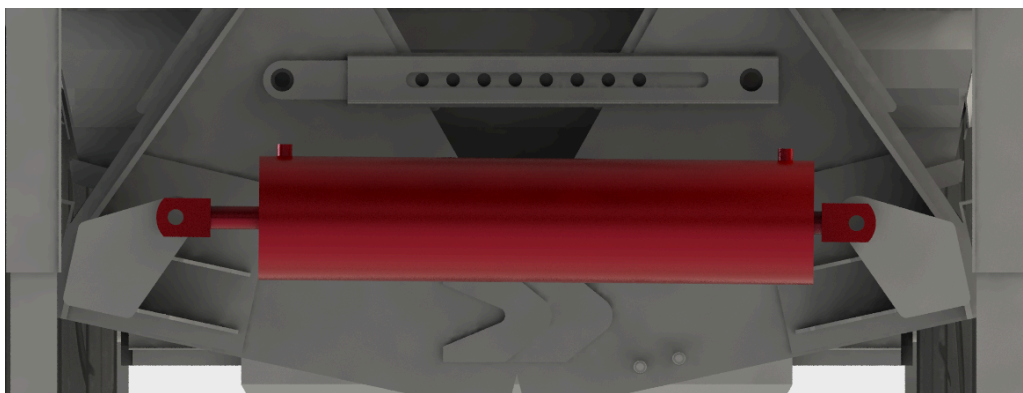

WARNING!

- ❗ Gates can open because to the weight of the cargo, resulting in property loss, major bodily injury, or death. Make sure the door is properly closed and fastened before getting behind the trailer or loading or towing it.
- ❗ Do not get behind a loaded trailer with door(s) open. The contents of the trailer could spill on you, inflicting serious harm or death.



BELLY DUMP

DOOR HARDWARE

ADJUSTMENT BAR

The bottom gate has an adjustment bar which is used determine opening levels of the door which has 9 adjustments according to the need of the user. The different opening options are predefined in the trailer and can be adjusted through a 3/4 pin with a safety clamp.

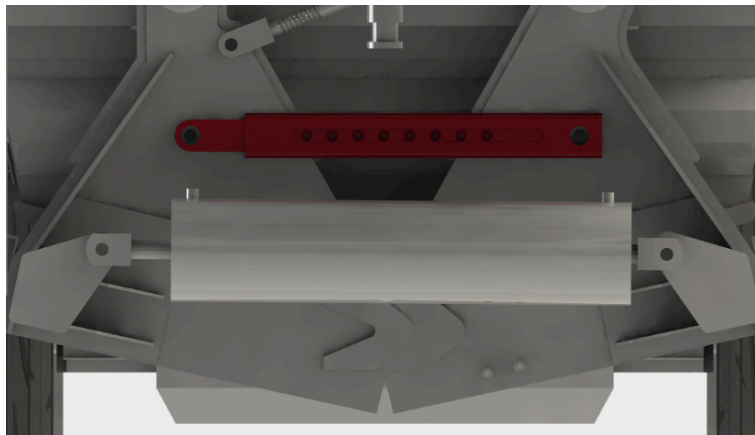

Part: ENS0002

TURNBUCKLE

The belly gate system includes a turn buckle which matches both gates to the same aperture and to open and close at the same level. It is manually adjustable by turning clock and counter clock wise the bolt to open one door or place it in the middle to open both gates



Part: ENS0001



BELLY DUMP

MAINTENANCE UNIT

Part: AR40-N04-Z-A

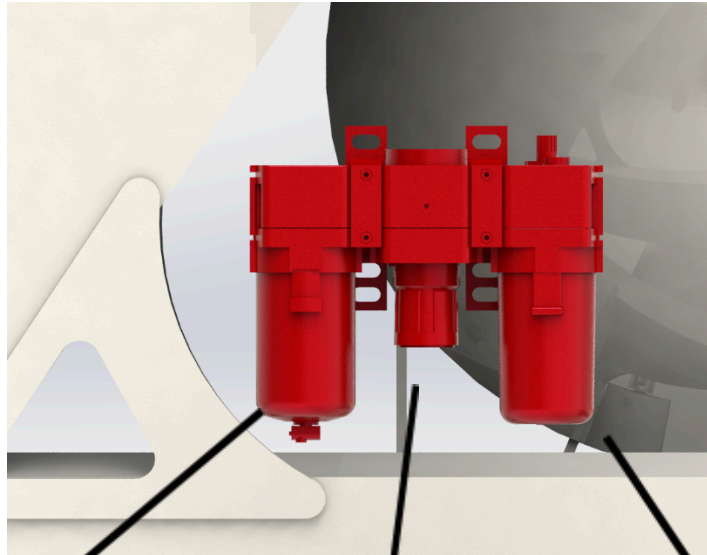

AIR FILTER

Part: 4A2-4CC

Filter is designed with a Separator & shield for efficient moisture separation.

AIR REGULATOR

Part: 482-7KF

Cost effective and clean looking, series AR regulators offer various pressure range settings to accommodate most applications. The locking adjustment knob prevents accidental setting changes. Options include a mounting bracket and set nuts for panel mounting, and a pressure gauge. The modular design of the AR series connects with other SMC air preparation equipment.

AIR LUBRICATORS

Part: 4C1-87L

Is used to supply lubricant to pneumatic equipment. These maintain a constant oil-to-air density over a wide range of flow.



Recommendation for lubrication
MARVEL MYSTERY OIL Air Tool Oil:
Petroleum



BELLY DUMP

PUSH PULL BLOCK

Our Push Pull Block is position at the bag off the trailer. The push-pull block's purpose is to push or tow the belly dump out if it becomes trapped. Its design contains an opening through which you may hook or tie up to tow and take out the trailer, whether you can pull or push. The design of the block also includes a notch on the bottom, allowing you to use a loader to push and raise at the same time.





BELLY DUMP

TARP SYSTEM

MOUNTING OPTION

- The electric tarp is switch activated from the truck's cab

TARP MATERIAL

- The variety of materials we have available are mesh tarp and vinyl tarp.
- Choose whichever fits better to your project.

FLIP TARP SYSTEM

STEALTH ARM SET

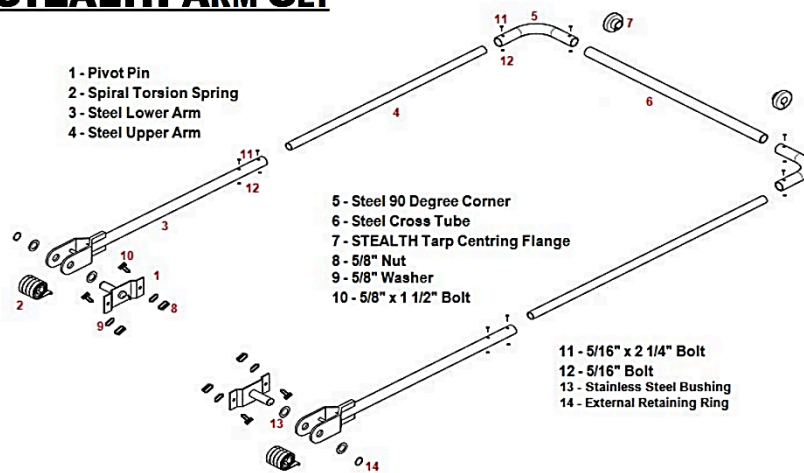

Part: STH-4SP-A



WARRANTY

Tarping Systems, Inc. is committed to providing the absolute best products and services at affordable pricing. We want your order to be right the first time and we understand that sometimes products may be lost, damaged in transit, or bear some sort of defect from the factory. To better serve our customers and ensure that our customers receive the quality products and service they have come to expect from Tarping Systems, Inc., We have put the following policies in place.

SALES: All sales are final. An order confirmation will be sent via email or fax for the buyer's confirmation once the order is received at Tarping Systems, Inc. It is the buyer's responsibility to read the said confirmation and verify that the order is correct. No response to the email or faxed order confirmation will be viewed as confirmation that the said order is correct. All orders made via purchase order will be considered by Tarping Systems, Inc. as confirmation of the order by the buyer.

SHIPPING: All orders are shipped F.O.B. from Slocumb, Al. There will be no full freight allowed or prepaid shipment accepted unless quoted and approved in writing prior to acceptance of the order. All shipments are made by most reasonable means in accordance with size and weight of order unless specific routing instructions are furnished by the customer and approved in writing prior to acceptance of order.

Shipments are made daily via FedEx and Saia. Tarping Systems is not responsible for shipping delays once the shipment has left our facility and is in the carrier's possession. To ensure delivery of orders, we need your company name, person of attention, street address, city, state, and phone number. No exceptions.

Any shipment, delivery, or performance date or associated fees stated in an Order, Tarping Systems, Inc. Invoice or other contract document are an estimate and approximation only and does not constitute any guarantee of shipment, delivery, performance or fees on any particular date. TSI will not be liable for any or all damages resulting from any delay or early shipment, regardless of the cause of the delay or early shipment. Unless otherwise expressly stated, Tarping Systems, Inc., shall have the right to make any delivery in installments, and/or may require Buyer accept shipments in full cartons/loads for some Products. Tarping Systems, Inc. reserves the right to modify an order based on Product availability. Further, any quotation of freight, transportation, shipping, handling, or similar charges are estimates only; if such charges are included in the Price, any increase in rates becoming effective after the Order.

SHORTAGES / DAMAGES: **Claims for shortages and damages must be made within 10 days with Tarping Systems, Inc.** When you receive your shipment, examine it carefully. Be sure that all cartons listed on the delivery sheet are accounted for. Large items, such as steel or aluminum tubing, may be packaged separately. If a carton is damaged, open it and inspect the contents before signing for delivery. If merchandise is damaged, describe the damage on the delivery receipt. Failure on the receiver's part to document damaged or missing merchandise on the delivery receipt releases the carrier and shipper of liability; repair or replacement will be the customer's responsibility.



RETURNS: All returns must be done within 14 days of delivery. The customer must obtain an RMA number before returning the product. **Items received without an RMA number clearly marked on the shipment will be refused.** You can obtain an RMA number from your Tarping Systems, Inc., representative.

CUSTOM TARPS: All custom ordered tarps should be drawn exactly as desired and the drawing should accompany a written purchase order. Some custom tarp orders will require extra time and materials that may warrant additional charges. Custom ordered products are not returnable or refundable.

RESTOCKING FEE: A 15% restocking fee will apply to all **stock** tarps. A 50% restocking fee will apply to all cable systems. A 20% restocking fee will apply to all front to back systems and incurmay a \$50.00 handling fee for painting/refurbishing if needed.

REFUNDS: Refunds for returns to Tarping Systems, Inc., will be minus any restocking fees, shipping charges incurred by TSI at any time during the transaction and/or refurbishing fees. All refunds will be applied to the method of payment provided to TSI for purchase. In the event that items are returned due to error by TSI, the customer will receive a full refund.

TARP MOTOR WARRANTY: Tarp motors are under warranty from the moment they leave our shipping warehouse until the pre-determined length of the warranty has come due (3 or 5 years). We have a system in place that tracks motor serial numbers from the time they are invoiced up until the expiration of the warranty. The standard procedure for activating a motor warranty is as follows:

- Ensure that the motor has not been physically damaged in any way. External damage to the motor caused by loaders, falling debris, tree limbs, etc. automatically voids the warranty.
- Ensure that the motor has not been separated from the gear box. Our tarp motors are married to the gear box. This helps us guarantee safe operation and any attempt to open the motor or gear box automatically voids the warranty.
- Ensure that the circuit breaker is properly installed. Using the tarp motor with an improperly or not installed circuit breaker voids the warranty of the tarp motor. The circuit breaker controls the flow of electricity to the motor reducing damages by power surges.
- Call your sales representative at TSI at **888-838-3229**. At this time the sales representative will ask you a few questions about the tarp motor to include the three items listed above and the sales representative will confirm that the tarp motor's serial number is in fact under warranty and for the customer to provide a proof of purchase.
- Box up and ship back the defective unit and **Proof of Purchase** to:
**Tarping Systems,
Inc. 215 Smith Road Slocomb, Al 36375**
- After TSI receives and inspects the tarp motor, a replacement motor will be sent out to you at no cost.

MANUFACTURERS GAURANTEE: Tarping Systems, Inc. acknowledges that sometimes the manufacturing process yields defects and sometimes shipping causes damage. In the event that we do not catch a defective unit prior to shipping, or if an item is delivered in sub-par condition then we are committed to making sure that your experience with TSI is one that you will brag about to other people.

Apart from the items listed below, Tarping Systems, Inc. warranties all its products to be free from defects in material and workmanship for a period of thirty (30) days from the date of invoice

Product	Warranty Period
Tarps	30 days from date of invoice
Tarp Motors: APACHE &TOMAHAWK™	36 months from date of invoice
Tarp Motors: ENFORCER & DRONE	60 months from date of invoice
SlingShot Spring	36 months from date of invoice
Steel and Aluminum Side Arms	365 days from date of invoice



INGENIERIA EN TRANSFORMACIONES METALICAS SA DE CV

Ascensión - Cd Juárez #2670, Col. Villa Esperanza
 C.P. 32695 Cd Juárez, Chih., México
 Tel: +52 (656) 559-6148, 49
 calidad@intrametmx.com
 www.intrametmx.com

ONE YEAR WARRANTY POLICY

INGENIERIA EN TRANSFORMACIONES METALICAS SA DE CV and related companies (seller) warrants its new products to be free from defects in material or workmanship under normal legal use and service for a period of **ONE YEAR FROM THE DATE OF PURCHASE** (delivery). Sellers ' sole obligation, at its option, will be to repair or replace any products returned PRE-PAID to the factory, which upon inspection by INTRAMET are determined to be defective in material and/or workmanship.

Warranties shall not apply to normal wear and tear, maintenance, poor or lack of service, adjustment, or accident. Also not covered is any equipment which has been altered or had unauthorized repaired in any way, or any items determined to be misused, or poorly maintained.

Warranties shall not apply to components manufactured by persons other than INTRAMET including, but not limited to; cylinders, tires, suspension, axles, bearings, etc.

Any claim under this warranty must be submitted by written notification detailing the defect to INTRAMET in Ciudad Juarez Chihuahua, Mexico. Product must be authorized in writing by INTRAMET before being returned to the factory, transportation charges prepaid.

Seller makes no warranties, either expressed or implied, except as provided herein, including without limitation thereof, warranties as to the marketability, merchantability, or suitability for a particular purpose or use. In no event shall Seller be liable for any direct, incidental or consequential damages of any nature, or losses or expenses resulting from any defective product or the use of any such product, including any damages for the loss of time, inconvenience, or loss of use of any such product.

This warranty in no way obligates INTRAMET to bear any costs of field testing, transportation, or third-party repairs. INTRAMET reserves the right to change our specifications or designs at any time.

DATE OF PURCHASE: _____ MODEL: _____ COLOR: _____ TYPE: _____

VIN#																							
CONFIRM VIN:																							
SUSP. SERIAL NUMBER:																							
SUSPENSION MAKE:																							

COMPANY NAME: _____ CONTACT: _____
 ADDRESS: _____ CITY, STATE, ZIP: _____
 DEALER: _____ PHONES: _____
 LOCATION: _____ SALESMAN: _____

PRODUCT MUST BE REGISTERED WITHIN 30 DAYS OF PURCHASE TO ACTIVATE WARRANTY. FOR MORE INFORMATION, PLEASE CONTACT YOUR DEALER.

I HAVE READ AND UNDERSTAND THE ABOVE WARRANTY AND VERIFY THAT THE INFORMATION PROVIDED IS CORRECT TO THE BEST OF MY KNOWLEDGE.

 CUSTOMER SIGNATURE

 CUSTOMER NAME

 DATE



Ingeniería en Transformaciones Metálicas S.A de C.V

**Address: Ascensión - Cd Juárez #2670,
Col. Villa Esperanza, 32695 Cd Juárez, Chih., México**

+52 656 559 6148

calidad@intrametmx.com

Intramet



calidad@intrametmx.com

+52 656 559 6148

www.intrametmx.com